

Parts checklist

- Handset
(1 for CLP99183)
(2 for CLP99283)
(3 for CLP99353/CLP99383)
(4 for CLP99453/CLP99483)
(5 for CLP99553/CLP99583)
- Charger with power adapter
(1 for CLP99283)
(2 for CLP99353/CLP99383)
(3 for CLP99453/CLP99483)
(4 for CLP99553/CLP99583)
- Telephone base
- Telephone line cord
- Telephone base power adapter
- Battery compartment cover
(1 for CLP99183)
(2 for CLP99283)
(3 for CLP99353/CLP99383)
(4 for CLP99453/CLP99483)
(5 for CLP99553/CLP99583)
- Battery
(1 for CLP99183)
(2 for CLP99283)
(3 for CLP99353/CLP99383)
(4 for CLP99453/CLP99483)
(5 for CLP99553/CLP99583)
- User's manual
- Quick start guide

Basic steps to set up & operate your phone

- 1 Install telephone base & charger
- 2 Install handset battery
- 3 Install telephone base on the wall (optional)

- 4 Set date and time
- 5 Set ringer volume
- 6 Add a Bluetooth cell phone / headset
- 7 Download a cell phone directory
- 8 Record own announcement
- 9 Set number of rings

- 10 Directory
- 11 Caller ID

Plug!

Click!

DSL filter

If you have DSL high-speed Internet service, a DSL filter (not included) is required.

Click!

Click!

Plug!

1. Open the battery cover.
2. Insert the battery with the positive terminal facing up.
3. Close the battery cover.
4. Charge the phone by plugging the charging cable into a wall outlet and the phone's charging port. A speech bubble says "Light on!".

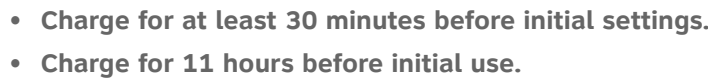

③

Flip down!

④

Click!

INSTALLATION COMPLETED!
Keep reading for common settings and operations.

1. Press **MENU** -> Press **▼/▲** to **Set date/time** -> Press **SELECT**.
2. Enter the month (**MM**), day (**DD**) and year (**YY**) -> Press **NEXT**.
3. Enter the hour (**HH**) and minute (**MM**).
4. Press **▼/▲** to choose **AM** or **PM** -> Press **SAVE**.

1. Press **MENU** -> Press **▼/▲** to **Ringers** -> Press **SELECT**.
2. Press **SELECT** to select **Ringer volume**.
3. Press **▼/▲** to choose the desired level -> Press **SET**.

1. Press **MENU** -> Press **▼/▲** to **Bluetooth** -> Press **SELECT**.
2. Press **SELECT** to select **Add device**.
3. Press **SELECT** to select **Add cellular**.
4. Disconnect the cell phone from any Bluetooth device -> Press **NEXT**.
5. Place the cell phone next to the telephone base.
6. Press **NEXT** to turn on the telephone base discoverable mode.
7. Turn on the Bluetooth feature of your cell phone and search for or add new devices. Once your cell phone finds your AT&T phone (**AT&T DECT 6.0**), press the appropriate key on your cell phone to continue the pairing process.
 - Enter the cell phone passcode (typically **0000**) if required -> **SET**.
 - Enter the PIN (default PIN: **0000**) of the telephone base into your cell phone if required.

1. Press **MENU** -> Press **▼/▲** to **Bluetooth** -> Press **SELECT**.
2. Press **SELECT** to select **Add device**.
3. Press **▼/▲** to **Add headset** -> Press **SELECT**.
4. Disconnect your headset from any Bluetooth device -> Press **NEXT**.
5. Set your headset to discoverable mode -> Press **NEXT**.
6. Press **▼/▲** to choose your headset if required -> Press **SELECT**.
 - Enter the PIN (typically **0000**) of your headset if required and press **NEXT**.

7

Download a cell phone directory

Before downloading a directory, make sure the cell phone is paired, active, and connected to your **CLP99183/CLP99283/CLP99353/CLP99383/CLP99453/CLP99483/CLP99553/CLP99583**.

To download a cell phone directory using the telephone base:

1. Press **MENU** -> Press ▼/▲ to **Bluetooth** -> Press **SELECT**.
2. Press ▼/▲ to **Download dir** -> Press **SELECT**.
3. Press ▼/▲ to choose among **Phone memory**, **SIM card only** or **Phone and SIM** -> Press **SELECT**.
4. Press **NEXT** to start downloading.
 - Enter the cell phone passcode, if necessary, then press **SET**.
 - Press a key on your cell phone to confirm the directory download.
5. Press **OK** to exit.

If you are using Bluetooth-enabled cell phones with Android® OS 2.3 or above, you may also download the **Connect to Cell™** application (consists of **Caller ID manager** and **Alerts manager**) using the Google Play® Store app to extend the flexibility of your **CLP99183/CLP99283/CLP99353/CLP99383/CLP99453/CLP99483/CLP99553/CLP99583**. Scan the QR code on the right to download the application.



8

Record own announcement

You can use the preset announcement to answer calls, or replace it with your own recorded announcement.

Using a cordless handset or the telephone base:

1. Press **MENU** -> Press ▼/▲ to **Answering sys** -> Press **SELECT**.
2. Press **SELECT** to select **Announcement**.
3. Press **SELECT** to select **Record annc**.
4. Facing the handset or telephone base, record your announcement and press **STOP** to end recording.

9

Set number of rings

You can set the answering system to answer an incoming call after 2, 3, 4, 5 or 6 rings, or toll saver. If you choose toll saver, the answering system answers a call after two rings when you have new messages, or after four rings when there are no new messages. This feature allows you to check for new messages and avoid paying long distance charges if you are calling from out of your local area.

Using a cordless handset or the telephone base:

1. Press **MENU** -> Press ▼/▲ to **Answering sys** -> Press **SELECT**.
2. Press ▼/▲ to **Ans sys setup** -> Press **SELECT**.
3. Press ▼/▲ to **# of rings** -> Press **SELECT**.
4. Press ▼/▲ to choose among **6, 5, 4, 3, 2** or **Toll saver** -> Press **SELECT**.

10

Directory

The directory stores up to 200 entries.

To add an entry in the home directory:

Using a cordless handset or the telephone base:

1. Press **MENU** -> Press ▼/▲ to **Directory** -> **SELECT**.
2. Press **OPTION** to select **Home**.
3. Press **SELECT** to select **Add contact**.
4. Enter a telephone number -> Press **NEXT**.
5. Press ▼/▲ to select **Home**, **Cell**, **Work** or **Other** -> Press **NEXT**.
6. Enter a name -> Press **SAVE**.

To review and dial a directory entry:

Using a cordless handset or the telephone base:

1. Press **DIR** on the handset, or press **DIRECTORY** on the telephone base in idle mode -> Press ▼/▲ to select the desired directory -> Press **REVIEW**.
2. Press ▼/▲ to browse through the directory, or press the dialing keys to start a name search.
3. Press **HOME** or **/SPEAKER** on the handset, or press **HOME** on the telephone base to call using the home line.

-OR-

Press **CELL 1** or **CELL 2** to call using the cell line.

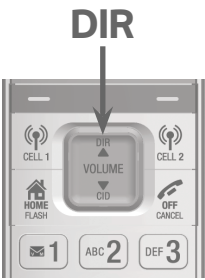

DIRECTORY



11

Caller ID

The caller ID log stores up to 50 entries.

To review and dial a caller ID entry:

Using a cordless handset or the telephone base:

1. Press **CID** on the handset, or press **CALLER ID** on the telephone base in idle mode -> Press ▼/▲ to scroll through the list.
 2. Press **HOME** or **/SPEAKER** on the handset, or press **HOME** on the telephone base to dial with the home line.
- OR-**
- Press **CELL 1** or **CELL 2** to dial with the cell line.



CID

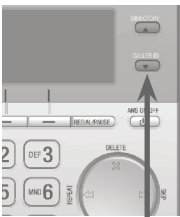

CALLER ID

To erase the missed call indicator:

Using a cordless handset or the telephone base:

The screens display **XX missed calls** when you have incoming calls that have not been answered. When you have reviewed all the missed calls, the missed call indicator is erased.

If you want to erase the missed call indicator without reviewing the caller ID log, press and hold **CANCEL** in idle mode.

Handset operation

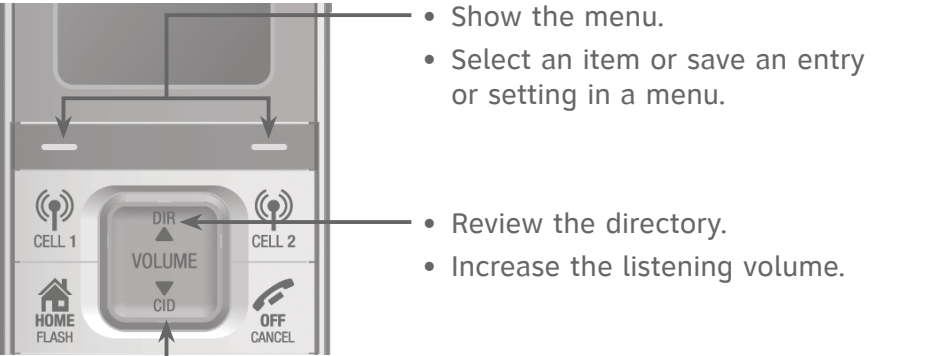

- Show the menu.
- Select an item or save an entry or setting in a menu.

- Review the directory.
- Increase the listening volume.

- Review the caller ID log.
- Decrease the listening volume.

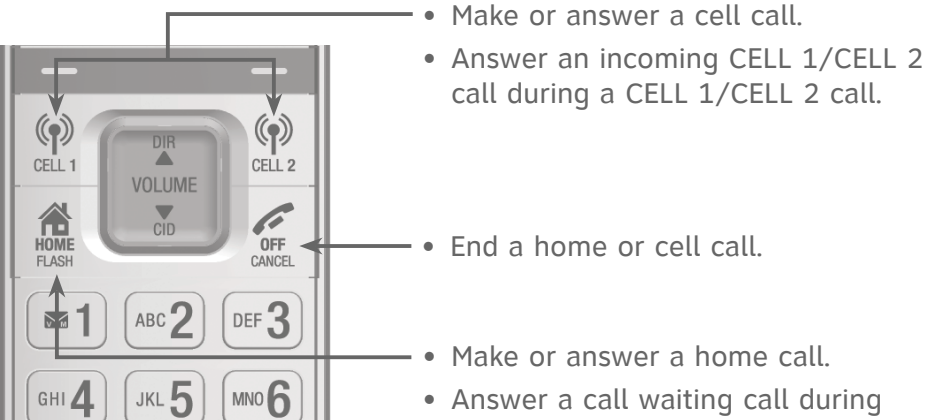

- Make or answer a cell call.
- Answer an incoming CELL 1/CELL 2 call during a CELL 1/CELL 2 call.

- End a home or cell call.

- Make or answer a home call.
- Answer a call waiting call during a home call.

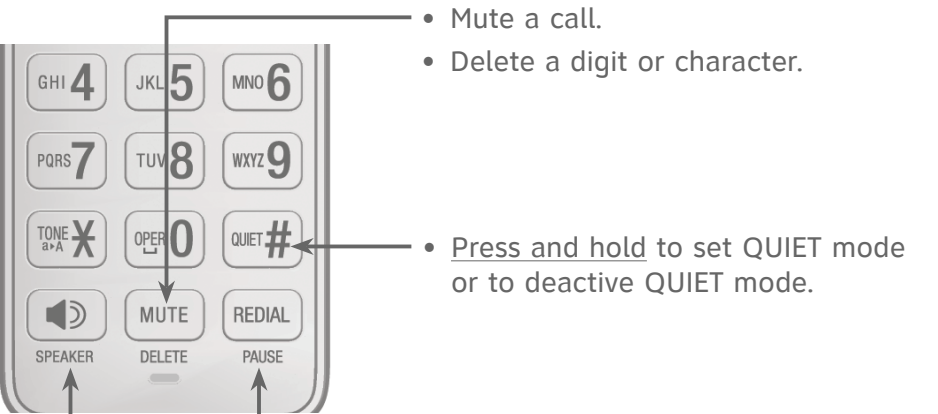

- Mute a call.
- Delete a digit or character.

- Press and hold to set QUIET mode or to deactivate QUIET mode.

- Press repeatedly to review the redial list.
- Add a dialing pause while dialing or entering a number.

- Make a home call using the speakerphone.
- Answer a home or cell call using the speakerphone.

Answering system operation

Your telephone has a built-in answering system and supports voicemail feature offered by your telephone service provider (subscription is required, and fees may apply).

Answering system and voicemail

To use the built-in answering system:

Refer to this Quick start guide for basic instructions. For complete instructions, see the user's manual in the package, or download it at www.telephones.att.com/manuals.

To use the voicemail:

Press and hold **1** to dial the preset voicemail number, and then enter a security code. Contact your telephone service provider for detailed information.

The built-in answering system must be turned on to answer and record messages.

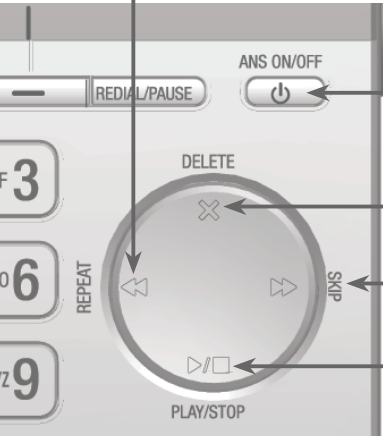

- Repeat the playing message.
- Press twice to listen to the previous message.

- Turn the answering system on or off.

- Delete the playing message.

- Skip to the next message.

- Start message playback.
- Stop messge playback.



- Adjust the speaker volume.

For a full set of installation and operation instructions, refer to the **CLP99183/CLP99283/CLP99353/CLP99383/CLP99453/CLP99483/CLP99553/CLP99583 DECT 6.0 cordless telephone/answering system with BLUETOOTH® wireless technology** user's manual in the package, or download it at www.telephones.att.com/manuals.

For customer service or product information, visit our website at www.telephones.att.com or call **1 (800) 222-3111**. In Canada, dial **1 (866) 288-4268**.

The *Bluetooth®* word mark and logos are owned by Bluetooth SIG, Inc. and any use of such marks by Advanced American Telephones and its parent, VTech Holdings Limited, is under license. VTech Holdings Limited is a member of Bluetooth SIG, Inc. Other trademarks and trade names are those of their respective owners.

© 2013-2014 Advanced American Telephones. All Rights Reserved.
AT&T and the AT&T logo are trademarks of AT&T Intellectual Property licensed to Advanced American Telephones, San Antonio, TX 78219.
Android® and Google Play® are registered trademarks of Google Inc.
Connect to cell™ is a trademark of Advanced American Telephones.
Printed in China. Issue 3.0 AT&T 10/14.

SETUP DONE!

Keep reading for some common operations.